

Precision + Style

Collection FLOORS

## PROJECT 5

# HOW TO FIT SCOTIA BEADING

A step-by-step guide to fitting scotia beading, using Richard Burbidge mouldings and basic woodworking tools and techniques.



#### TIME REQUIRED

Approximately 2 hours



#### TOOLS REQUIRED

- Richard Burbidge Scotia
- Tape Measure
- Pencil
- Mitre Saw
- Mitre Box
- Sandpaper
- Grab Adhesive\*
- PVA
- Hammer
- Nails
- Flexible Decorators Caulk
- Decorators Caulk
- Finishing Paint, Stain or Varnish



#### SAFETY

As a precautionary measure use a pipe and cable detector before nailing or drilling. For safety wear protective gloves, glasses and knee pads. When using a mitre box it's always a good idea to fix the box to a secure surface, to allow for both hands to be free when sawing. Ensure you do not drill directly above or below light switches or power sockets. Be sure to follow manufacturer's instructions when using all tools and materials.

\*Be sure to follow your chosen adhesive's instructions, you may also need to ventilate the room.

For further information or to find your nearest stockist visit: [www.richardburbidge.com](http://www.richardburbidge.com)

For technical support call: 01691 678 212

## PROJECT 5 HOW TO FIT SCOTIA BEADING

Wood flooring and laminate flooring require an expansion gap around the perimeter of the room as they naturally expand and contract. Scotia is a decorative moulding used to cover this expansion gap without removing the skirting board.

### STEP 1. Choose your Richard Burbidge moulding

Firstly you'll need to decide the style you're going for – we offer a wide range of scotia bead styles, from decorative to minimalist. Richard Burbidge mouldings are of the highest quality and can totally transform the look and character of a whole room. Top tip: Select a scotia style and colour that matches the skirting board for a cohesive look. Measure the perimeter of your room to determine the total length of scotia required, then add another 20% for wastage.



Choose from white oak, pine, primed pine, light hardwood and dark hardwood.

### STEP 2. Cutting the moulding

When joining two ends of scotia beading together they will need to be cut to a mitre joint, this means cutting at a 45 degree angle for a seamless finish. For internal and external corners measure the distance to the next corner and mark onto the back of the scotia, and the intended direction of the mitre cut. Next, use a mitre box and mitre saw at a 45-degree angle in the marked direction. Then cut the adjoining scotia to make a mitre cut in the opposite direction, sand both mitred ends until smooth. Hold both mitred ends together ensuring they fit properly. If the fit isn't exact you can use a block plane to shave down the ends to achieve a better fit. When fitting the end of the scotia flush to the wall, cut at a 90 degree angle.

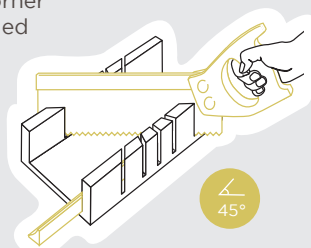

### STEP 3. Fitting a return

For installations where the end of the scotia is exposed, such as next to a door, fitting a return to the exposed end will achieve a neater finish. Firstly, make a mitre cut to the exposed end of the scotia. Next, complete a mitre cut on another piece of scotia in the opposite direction to the previous mitre cut, then cut this small piece to size. Ensure it fits into the exposed end of scotia, then apply PVA to the mitre and fit the return onto the scotia and flush to the wall.

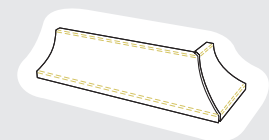

### STEP 4. Securing the moulding to the wall

You can opt for nails which offers a more reliable hold, or adhesive which allows for a more clean and professional finish. To fit scotia using nails, secure into position by nailing the scotia to the skirting by spacing one nail every 30cm, ensure you don't nail the scotia to the floor. To fit scotia using adhesive, apply grab adhesive to the back of the scotia and carefully apply to the wall, ensuring not to get any on your flooring. Apply PVA to any external mitres. Use flexible decorators caulk to fill any gaps between the top of the scotia and skirting, wipe any excess with a damp cloth to smooth the surface.

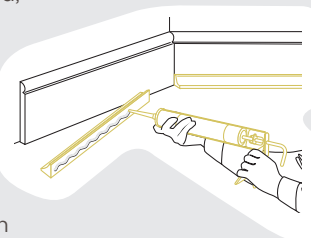

### STEP 5. Add the finishing touches

Once the scotia is applied, use decorators caulk to patch any gaps, cracks, or holes prior to finishing. If you have selected pine scotia, there are many different finishing options, you can stain for a traditional look, paint for a contemporary finish, or choose to retain the original look of raw pine. These little finishing touches are where you can tie in with your chosen décor and match your existing skirting. If you decide to stain or leave as it is, we recommend sealing the surface with a varnish or oil.

