

**The following instructions are for installing Richard Burbidge TREAD AND RISER KITS. If you have any queries please contact our Technical Helpline on 01691 678212.**

Note –

Please check all components carefully PRIOR to installation for any damage to the surface, as Richard Burbidge cannot be held responsible for any damage once installation has commenced.

Before commencing your installation, please read this guide carefully. The following is a generic guide as staircase layouts and sizes vary throughout the UK. Richard Burbidge cannot be held responsible for incorrect fitting mistakes so please take extra care.

The tread/riser kits are suitable for the sizes shown on the exterior label however the product can be cut to suit smaller sections if required. Please ensure the sizes are suitable for your staircase.

Tools Required to complete installation- nail gun, suitable adhesive, tape/ pencil, tape measure. A laser level is also helpful.

It is recommended to begin fitting the treads at the top of the flight and work down, to avoid walking on newly laid treads.



The tread/riser kits are available in single packs or three-packs. Each pack includes battens, a tread and a reversible riser with one side primed for painting.

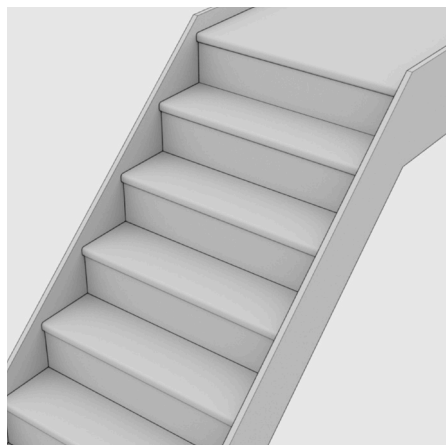
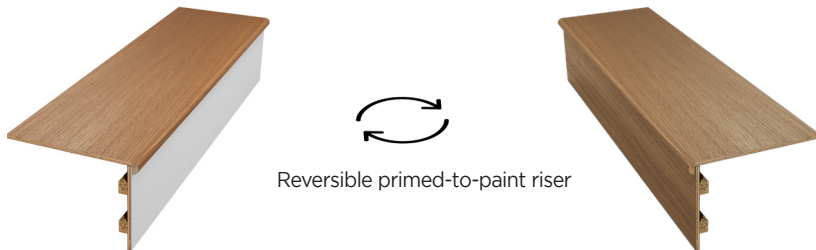

**Step 1** – before you begin, remove all floor covering, make sure that all step/riser surfaces are even and no surface defects, these can be sanded if needed, all surfaces should be clean and dry.

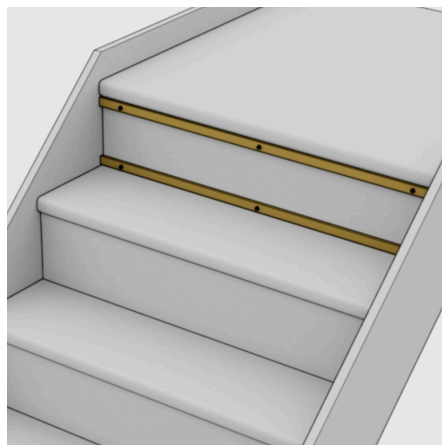

**Step 2** – prepare your timber battens, cut these to the width of the tread and screw into position.

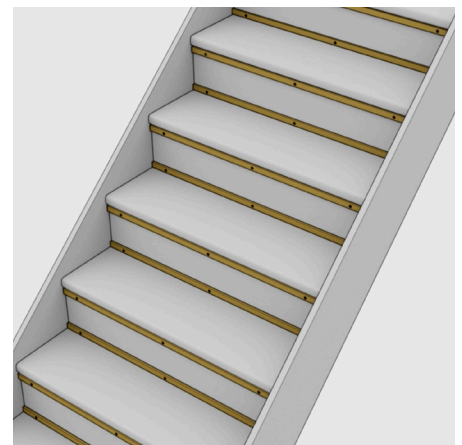

Continue to fit the battens to every step.

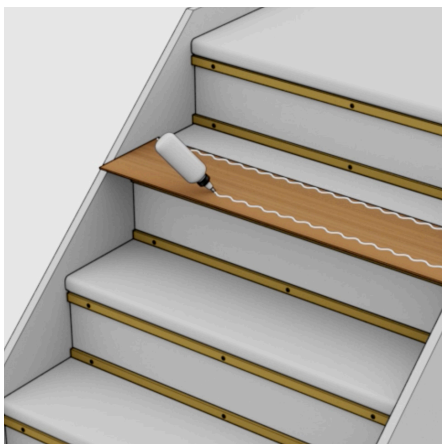

**Step 3** - cut two richard Burbidge risers to the correct sizes, glue these into place onto the packing battens...

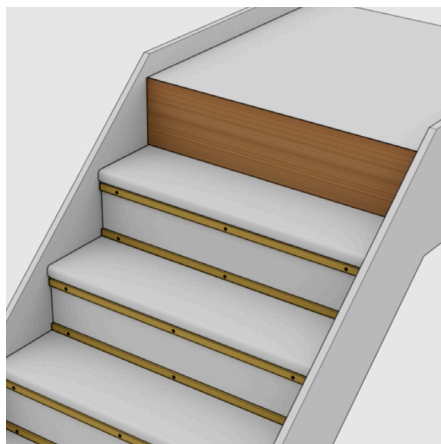

... this will hold them in place until the treads are secured

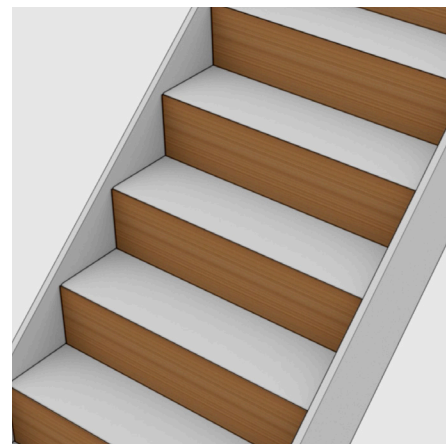

You can fit all the risers at this stage if you wish, or one step at a time.

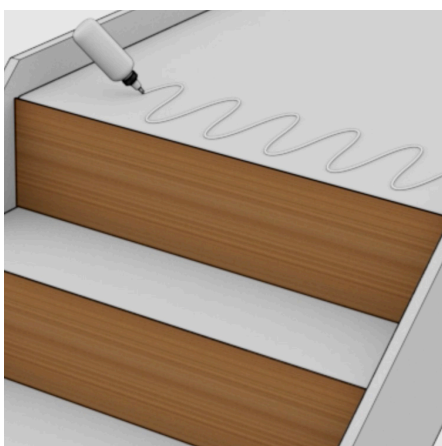

**Step 4** - apply an even/generous bead of polymer adhesive to the topmost tread. Mark and cut the tread to the correct size and lay onto the polymer adhesive.

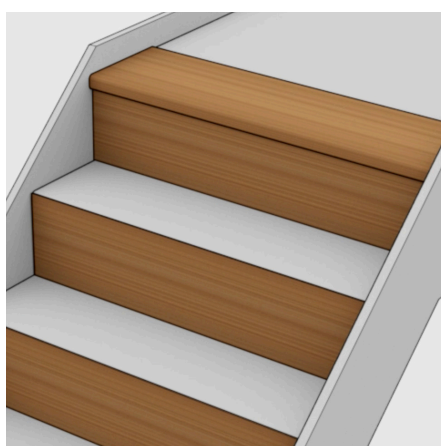

**Step 5** - Apply an even/firm pressure, making sure the tread nosing laps correctly over the riser, applying additional weights onto the top face of the tread may help.

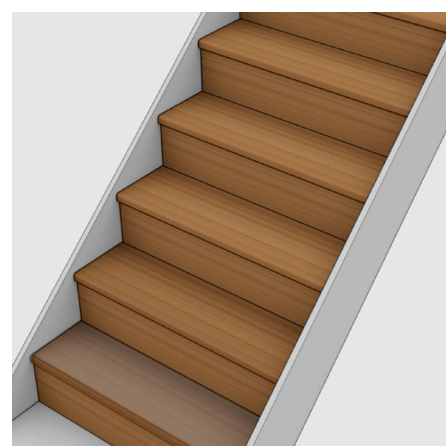

You can now repeat the process down the flight, riser first followed by tread. If there is a turn on the flight or a larger step you can use our tread extension kit at this point.

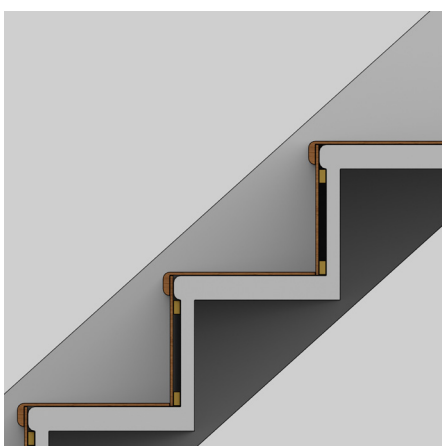

This is the side view of the installation of the tread/riser kit. When you have chosen the flooring that you intend to install on the top landing you should purchase the appropriate threshold to bridge the join between the two surfaces, if you are installing carpet you may chose to glue/pin this over the top and around the nosing for a neat finish.

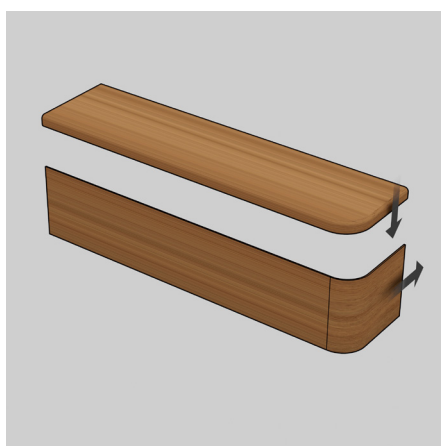

**Bullnose tread: left and right handed**  
Our bullnose kit is curved on the one side, and fits easily onto any curved first step. You will need to mark and cut the curved riser to the height, width and depth required for your step.

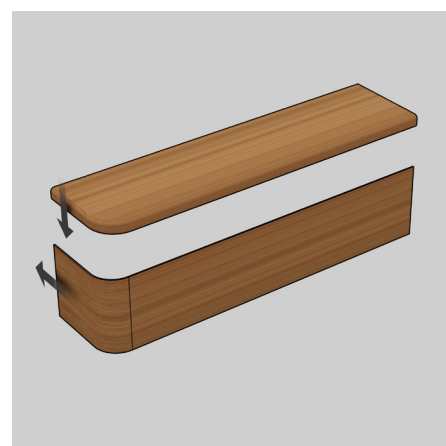

You can then offer this up to work out where the tread will rest on top of the riser. Trim the tread to fit the width and the back face of the tread to the correct depth (you may need to trim to affix around the newel post as well).

### **FINISHING ADVICE**

Our tread/riser kits are unfinished, allowing you to pick the colour of the finish you prefer, make sure you pick the correct type of finish and apply based on the manufacturer's guidelines. It is recommended to test on an offcut first to make sure the colour is to your desired effect.

Varnish is available in clear matt, satin and gloss finishes and also tinted/coloured, varnish gives a tough, durable and hardwearing finish which requires minimal maintenance and is heat and water resistant. Coloured varnishes have the advantage of being suitable for application on previously varnished surfaces. When applying coloured varnishes you should note that as they do not penetrate like a true wood stain/dye it is a good idea to finish with a couple of coats of clear varnish which will prevent colour loss due to wear and tear.

As well as polyurethane varnishes there are a number of acrylic/water-based varnishes which are solvent free, have a low odour and are extremely quick drying. They also have the advantage of easy brush maintenance and require only a quick rinse with water after use.

### **IMPORTANT REMINDERS-**

**AVOID LEAVING OBJECTS ON THE LOWER STAIRS WHILST FITTING**

**BEGIN INSTALLING TREADS AT THE TOP AND WORK DOWN**

**USE THE CORRECT ADHESIVE**

**DOUBLE CHECK MEASUREMENTS BEFORE YOU CUT.**

---

**Find out more at [www.richardburbidge.com](http://www.richardburbidge.com)**